

INSTRUCTION MANUAL IMPLEMENT STAY KIT (3C581-9701-0) for KUBOTA TRACTOR M5040 / M6040 / M7040 / M8540 / M9540

■ ASSEMBLY

1. Remove the M6 x 20 screws from the right-side window lock complete. (See Fig. 1)

[Fig. 1]

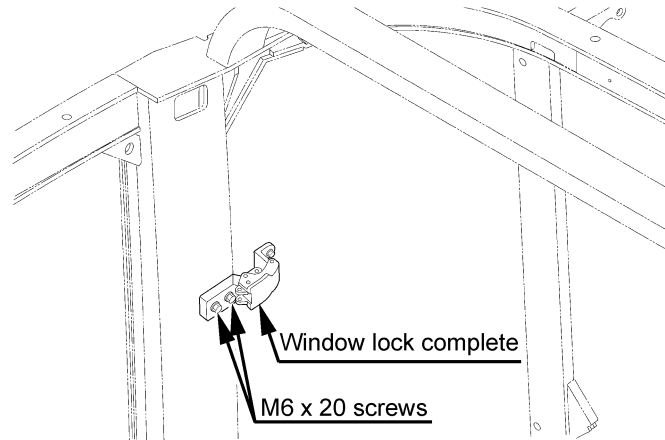

4CAKLAPAP001A

2. Fit the U groove of implement stay (010) to the cab post. Using the M6 x 35 flange bolts (020), tighten up the implement stay (010) and window lock complete together. (See Fig. 2)

◆ Tightening torque

M6 x 35 flange bolt : 9.8 to 11.3 N-m
(1.0 to 1.2 kgf-m, 7.2 to 8.3 ft-lbs)

3. Tighten up the M6 x 18 bolts (030) to get the lock nuts (040) tight. (See Fig. 2)

◆ Tightening torque

M6 x 18 bolt : 3.9 to 4.9 N-m
(0.4 to 0.5 kgf-m, 2.9 to 3.6 ft-lbs)

IMPORTANT :

- Make sure the lock nuts (040) are tight enough.
4. When the safety label hides under the implement stay (010), apply a new safety label (050) on the opposite-side cab post. (See Fig. 2)

■ PARTS LIST

[Fig. 2]

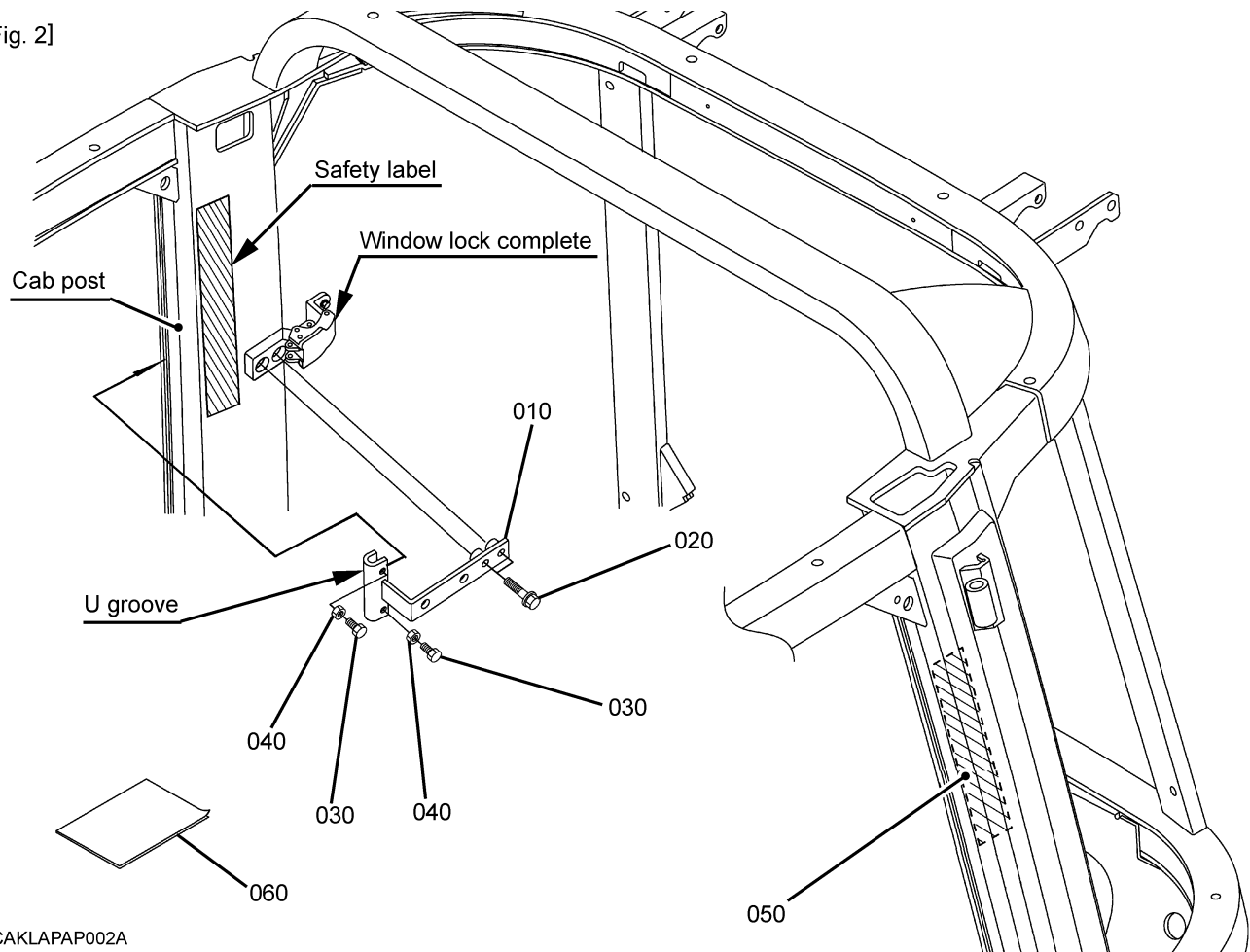

4CAKLAPAP002A

REF. No.	PART No.	PART NAME	Q'TY	REMARKS
010	3C581-5040-0	STAY, IMPLEMENT	1	
020	5H100-3290-0	BOLT, FLANGE	2	M6 x 35
030	11196-7735-0	BOLT	2	M6 x 18
040	02012-60060	NUT	2	
050	3F240-9836-2	LABEL, SAFETY	1	
060	3C581-9791-0	MANUAL, INSTRUCTION	1	This paper